

Draw a Fastener or Hardware Component

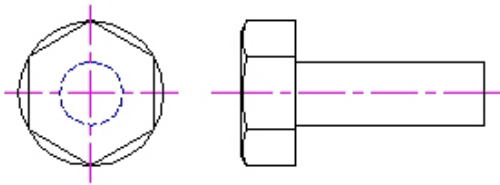

Hex Head Screw

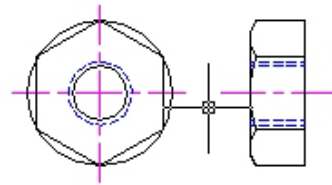

Hex Nut

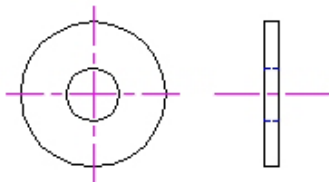

Washer

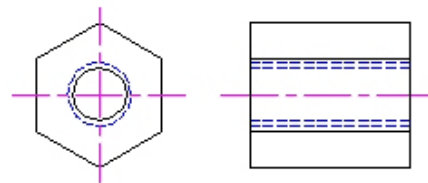

Standoff

The Instructions

Add the code to the `cmdClear` subroutine.

Add the code to the `cmdExit` subroutine.

Add the code *Draw Fastener* to the `cmdDrawFastener` subroutine.

Go to Insert Module and type:

```
Sub DrawFastener()  
    FrmFastener.Show  
End Sub
```

Under the General Declarations section of the code, write the subroutine to draw the fastener.

The Code

Write your code using keycode concepts.