

Appendix

B

Circular Challenge 1

So you think you're pretty good? Here are some additional Circular Problems to try without step-by-step instructions. Every skill needed to draw these parts has been covered in Chapters 5, 6, and 7; it may take some trial and error to discover exactly what method works best in different situations.

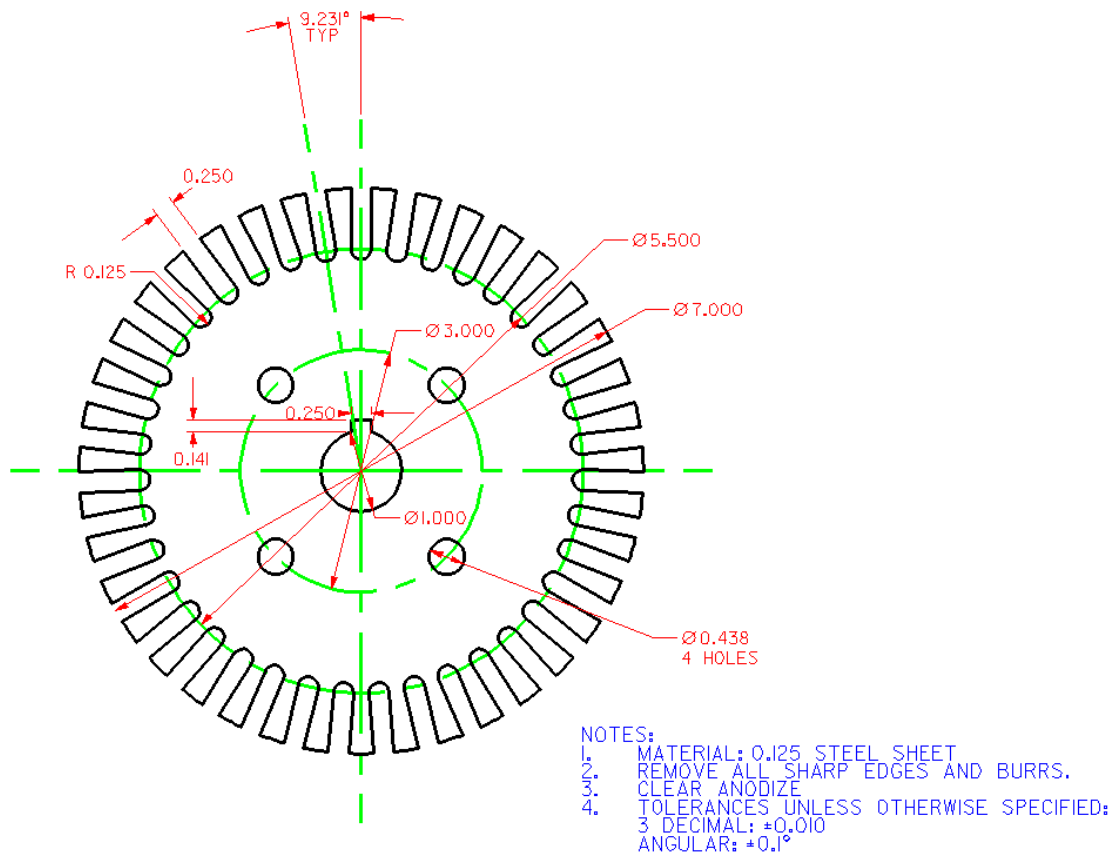

Figure B.1 – A Stamping

*** World Class CAD Challenge 02-A3 * - Create a New file and draw the entire Stamping on proper levels, using proper dimensions and finally placing the notes on the drawing. Continue this drill four times, each time completing the drawing under 15 minutes to maintain your World Class ranking.**

Send your best time and a copy of your drawing for verification to the authors of these problems to have your name, location and time posted. See the web site for instructions.

www.worldclasscad.com

Appendix

B

Circular Challenge 2

This drawing is present to challenge anyone with the time and the energy to duplicate the standards of the Circular problem. The drawing requires the same skill set as learned in Unit 2, so you should be able to achieve a similar CAD drawing time and accuracy score.

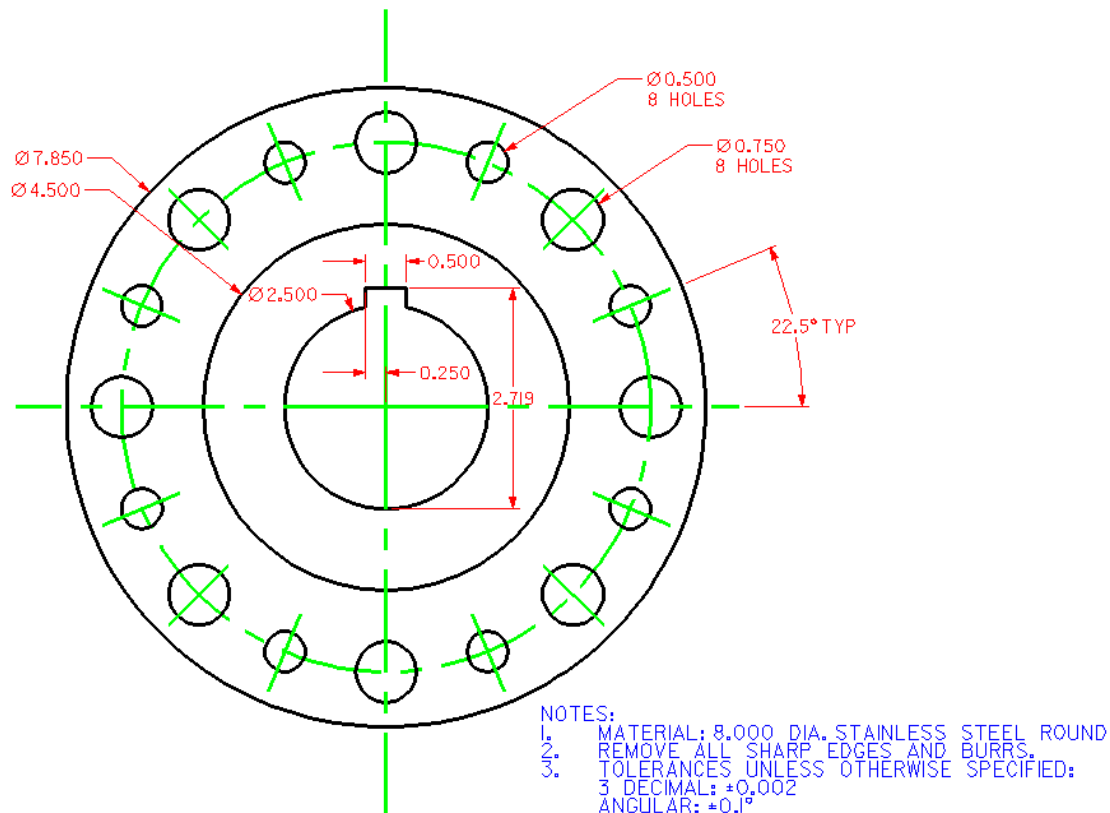

Figure B.2 – A Hub

*** World Class CAD Challenge 02-A4 * - Create a New file and draw the entire Hub on proper levels, using proper dimensions and finally placing the notes on the drawing. Continue this drill four times, each time completing the drawing under 15 minutes to maintain your World Class ranking.**

Send your best time and a copy of your drawing for verification to the authors of these problems to have your name, location and time posted. See the web site for instructions.

www.worldclasscad.com